



# Shield

User Guide

# CPR Call Blocker App

Now you can block Nuisance Calls & SMS messages to your mobile device with **CPR Call Blocker** for Android!

Download our Free App



Don't forget to pass this onto your family and friends!

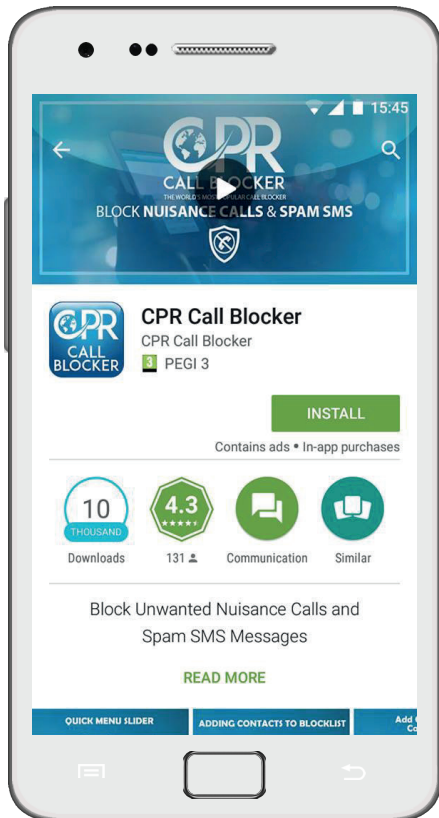

# Standard Set Up

1.

Unplug the Line Cable from the telephone.

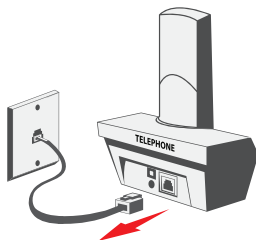

2.

Insert the Line Cable into the **LINE** port of the Call Blocker.

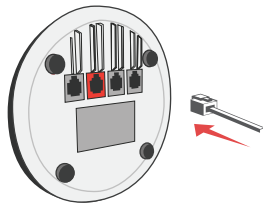

3.

Insert the short black cable provided into the **TEL** port, placing the other end into the telephone.

Check for a dial tone. A blue light on the Call Blocker indicates it is set up correctly.

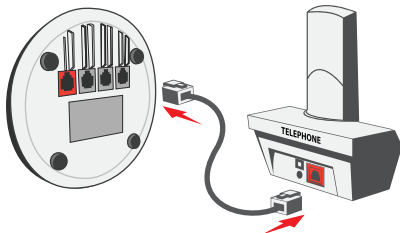

**UK Note:** If there are no blue lights on the Call Blocker when you check for a dial tone, try reconnecting using the LINE 1 and TEL 1 ports.

# Parallel Set Up

1.

If caller ID or intermittent ringing issues arise, try the parallel setup method.

Unplug the Line Cable from the telephone.

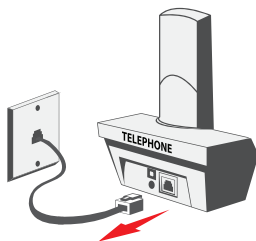

2.

Insert the Line Cable into the **LINE** port of the Call Blocker.

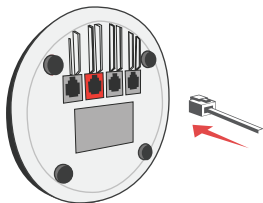

3.

Insert the short white cable provided via the red coloured connection into the **LINE1** port, placing the other end into the telephone.

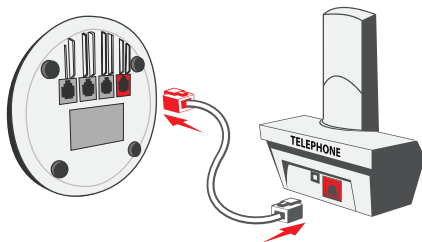

Check for a dial tone. A blue light on the Call Blocker indicates it is set up correctly.

# ADSL / DSL Set Up

1.

Unplug the Line Cable from the telephone.

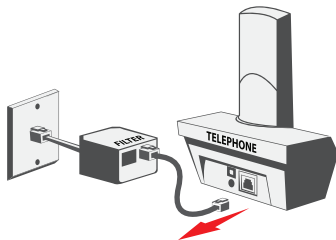

2.

Insert the Line Cable into the **LINE** port of the Call Blocker.

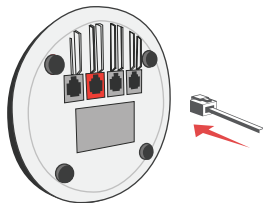

3.

Insert the short black cable provided into the **TEL** port, placing the other end into the telephone.

Check for a dial tone. A blue light on the Call Blocker indicates it is set up correctly.

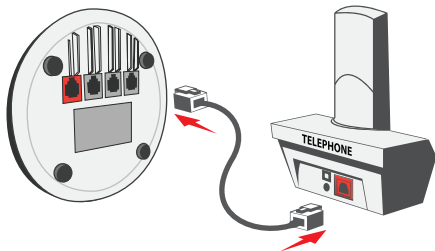

# Router/Modem Set Up

1.

Unplug the Line Cable from the telephone.

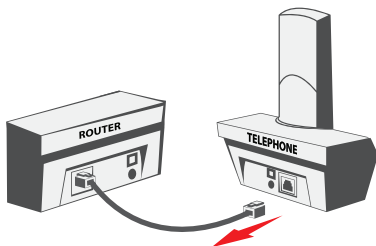

2.

Insert the Line Cable into the **LINE** port of the Call Blocker.

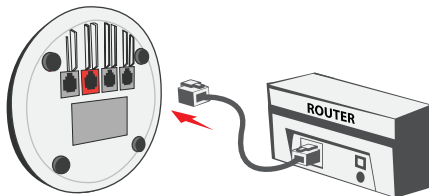

3.

Insert the short black cable provided into the **TEL** port, placing the other end into the telephone.

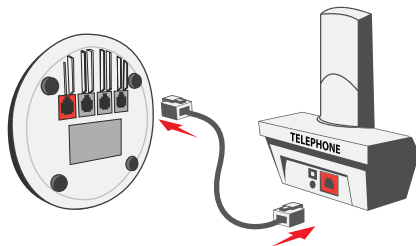

Check for a dial tone. A blue light on the Call Blocker indicates it is set up correctly.

# Your First Unwanted Call

1.

After installing your Call Blocker, take calls in your usual manner.



2.

If the call is unwanted, simply press the **BLOCK NOW** button.  
(The number must be visible on the telephone)



3.

The number will then be added to the block list, and  
cannot call you again.



4.

If using a cordless DECT phone system, press # then **2** (during a call)  
from any handset to activate the block now function. Then hang up.  
(The number must be visible on the telephone)



# Additional Programming Codes

## How to enter codes

Pick up the phone and get a dial tone, then enter any of the codes below. You will hear a single “beep” after each # to confirm successful entry. You will hear multiple “beeps” if a code or number has already been entered.

## Add/Remove blocked numbers or area codes

Add: **\*\* 7 # (beep)** Number or Area Code **# (beep)**

Remove: **\*\* 6 # (beep)** Number or Area Code **# (beep)**

## Additional blocking features

1. Turn on: Blocking all “Withheld/Private Callers” - **\*\* 7 # (beep) 7 \* # (beep)**  
Turn off: Blocking all “Withheld/Private Callers” - **\*\* 6 # (beep) 7 \* # (beep)**
2. Turn on: Blocking all “International/Out of Area Callers” - **\*\* 7 # (beep) \* # (beep)**  
Turn off: Blocking all “International/Out of Area Callers” - **\*\* 6 # (beep) \* # (beep)**
3. Turn on: Blocking all “Unavailable Callers” - **\*\* 7 # (beep) # (beep)**  
Turn off: Blocking all “Unavailable Callers” - **\*\* 6 # (beep) # (beep)**
4. Turn on: Blocking all “International numbers with 00 prefixes” - **\*\* 7 # (beep) 0 0 # (beep)**  
Turn off: Blocking all “International numbers with 00 prefixes” - **\*\* 6 # (beep) 0 0 # (beep)**
5. Turn on: Blocking all “VOIP/IP Rogue Dialler Callers” - **\*\* 7 # (beep) 6 \* # (beep)**  
Turn off: Blocking all “VOIP/IP Rogue Dialler Callers” - **\*\* 6 # (beep) 6 \* # (beep)**
6. Reset Call Blocker back to factory settings - **\*\* 1 # (beep) \* 1 # (beep)**



# FAQ (Frequently Asked Questions)

## **Q: Do I need caller ID for the Call Blocker to work?**

A: Yes, caller ID should be enabled on your telephone line for the Call Blocker to work effectively.  
(without caller ID the Call Blocker will block all calls)

## **Q: I am getting a busy signal when trying to enter the programming codes?**

A: Some telephone line providers use network codes that may conflict with the Call Blocker's \* \* settings. To overcome this, get a dial tone and hold the BLOCK NOW button for 5 seconds. This will set the Call Blocker into programming mode and should now allow the codes to be entered.

## **Q: Can I use the CPR Call Blocker with telephone extension sockets?**

A: Yes you can, but problems can arise. The CPR Call Blocker is designed to work on one telephone socket (master socket). If you wish to have additional phones around the house, it is best to use a DECT (Digital Enhanced Cordless Telephone) setup with multiple cordless handsets so that the Call Blocker can protect all of the phones connected to the main base station at the master socket / wall jack.

## **Q: I am unable to get a dial tone when the Call Blocker is connected?**

A: Reconnect using the alternative ports, either LINE1/TEL1 or LINE/TEL. If you are still unable to get a dial tone, please call technical support for assistance.

## **Q. The blue light is not activated on my Call Blocker?**

A: if you have the Call Blocker connected using the LIN E and TEL ports, simply switch over to the LINE1 and TEL 1 ports. The same thing applies to those using LINE1 and TEL1 ports, simply switch them over to the LINE and TEL ports.

## **Q: I have lost caller ID on my phone when the CPR Call Blocker is attached, what do I do?**

A1: This is usually caused by overloading of additional telephone equipment on your line. Try disconnecting some telephone equipment to see if caller ID returns.

A2: Poor quality ADSL/DSL filters can also cause caller ID issues. To test this try removing the ADSL/DSL filter and see if caller ID returns, if caller ID returns the ADSL/DSL filter is at fault and will need to be replaced with a high quality branded version

A3: If the above workarounds fail, connect the Call Blocker unit up IN PARALLEL.

## Extended Warranty

To extend your warranty please visit the website  
[www.cprcallblocker.com/warranty](http://www.cprcallblocker.com/warranty)

# Notes

# Contact Us

Should you need assistance setting up your Call Blocker or have any questions, please call or email our friendly technical support team who will be happy to help.

Email: [support@cprcallblocker.com](mailto:support@cprcallblocker.com)

UK Tech Support: 0800 652 7780

USA Tech Support: (408) 872 6822

Australia Tech Support: (02) 8005 5793

International Tech Support: (+44) 800 652 7780

Skype: [cprcallblocker](#)

UK  
CPR Call Blocker  
York Chambers  
York Street  
Swansea  
SA1 3LZ

USA  
CPR Distribution  
616 Corporate Way  
Suite 2 - 6892  
Valley Cottage  
New York  
10989

AUS  
CPR Call Blocker  
Level 20 Tower A  
821 Pacific Hwy  
Chatswood  
NSW 2067

[www.cprcallblocker.com](http://www.cprcallblocker.com)

© CPR Call Blocker 2016



Thank you for purchasing the  
**Shield Call Blocker**

from the  
*CPR Team*